

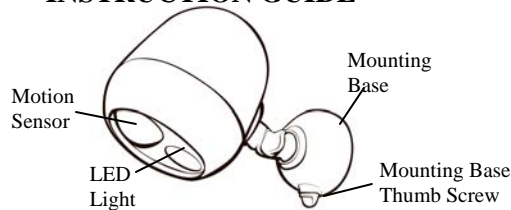

WIRELESS LED MOTION FLOOD-LITE INSTRUCTION GUIDE

2700 Port Road
Columbus, Ohio 43217
www.dorcy.com
www.dorcydirect.com
1-800-837-8558



FEATURES

Thank you for purchasing the Dorcy Wireless LED Motion Flood-Lite. We are committed to eliminating darkness by using the latest in light-emitting diodes (LED's). LED's are the most efficient and durable light sources available. We are certain that your Flood-Lite will contribute to a safer environment and provide light where you need it at a very reasonable cost.

ENCLOSED YOU WILL FIND:

- Wireless LED Motion Flood-Lite
- Mounting Base
- 3 Screws and 2 Anchors

Motion Sensor Activated – You can set the on-time of the light at 30 seconds or 2 minutes. Light shuts off automatically if no motion is detected.

Light Sensor – Wireless LED Motion Flood-Lite goes on only in darkness to conserve battery life.

2 Brightness Settings – Choose “High” for maximum light, and “Low” for maximum battery life.

Fully Adjustable – Wireless LED Motion Flood-Lite can be rotated 360° as well as up and down.

WARNING

- Use only new alkaline or lithium D-Cell batteries with 1.5V rating. Do not mix old and new batteries. Install batteries with polarity in correct position.
- Follow battery instructions for proper disposal and cautions.
- Mount fixture securely with included screws, and use anchors if not securing to solid wood or other solid material. **Use the third screw if mounting Flood-Lite upside down!**

INSTALLATION INSTRUCTIONS

BEFORE YOU MOUNT YOUR FLOOD-LITE

Illustration 1a



Illustration 1b



Illustration 2

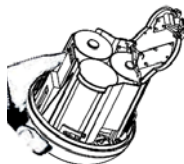

Illustration 3a



Illustration 3b



Illustration 4

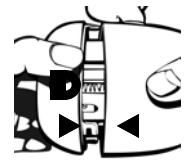

1. Remove front cover of Flood-Lite by rotating counter-clockwise as shown in **Illustration 1a** to reveal controls and battery holders. Insert 3 D-Cell Batteries into Flood-Lite as shown in **Illustration 2**.

2. Set your automatic shut-off time to 30 seconds or 2 minutes (**Illustration 3a**). **NOTE:** Light will stay on as long as motion is detected. **We recommend 30 seconds.**

3. Set your brightness to “Low” or “High” (**Illustration 3b**). Note: High will provide the equivalent light of a 25W incandescent bulb. **Match arrows then turn cover clockwise (Illustration 4).**

NOTE: Please use only new alkaline or lithium D-Cell batteries with 1.5V rating. Do not mix old and new batteries. Install batteries with polarity in correct position as shown. **Flood-Lite only goes on in complete darkness! Test in a dark room or drawer.**

MOUNTING YOUR FLOOD-LITE

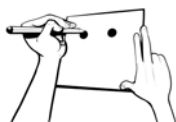
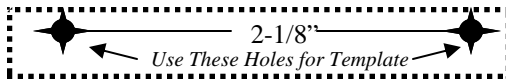

Illustration 5

Determine location for mounting Flood-Lite. **NOTE: FOR BEST PERFORMANCE, FLOOD-LITE SHOULD BE POSITIONED SO MOTION SENSOR IS ON TOP AND LIGHT IS ON BOTTOM.** Use template (above) to mark two holes for anchors and/or screws (included) as shown in **Illustration 5**. **NOTE:** Flood-Lite can be rotated 360°, so screws can be mounted in any position. We recommend mounting the screws parallel to the ground if mounting on a vertical surface. Make sure that screws are precise distance from each other as configured in template (2-

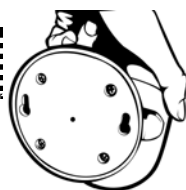

Illustration 6

Attach Mounting Base to screws as shown in **Illustration 6**. Slide Mounting Base down so screws are securely held by track. If using anchors, use 3/16” drill bit to drill holes and insert anchors. Drive screws into anchors so that screw head protrudes 1/8” from surface (the height of the screw head). If using screws only, use 1/8” drill bit to drill holes and insert screws so that screw head protrudes 1/8” from surface (the height of the screw head). Drive large screw through center hole as shown in **Illustration 7**.



Illustration 7



Illustration 8

To attach Flood-Lite to Mounting Base, align holes then insert and tighten thumb screw (**Illustration 8**). To adjust Flood-Lite direction, loosen smaller thumbscrew on Mounting Base and rotate Flood-Lite to proper direction as shown in **Illustration 9**. Tighten thumbscrew.



Illustration 9

Loosen larger thumbscrew that connects Flood-Lite Head to Mounting Base and adjust Flood-Lite Head to proper direction as shown in **Illustration 10**. Tighten thumbscrew.

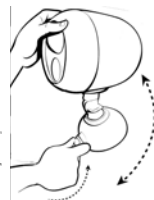

Illustration 10

ONE YEAR WARRANTY

The product you have purchased is guaranteed against defects in workmanship and materials for one year from the date of purchase. If the product fails due to a manufacturing defect during normal use, return the product and dated sales receipt to Dorcy International, 2700 Port Road, Columbus, Ohio.

Not Covered – Batteries are not covered by this warranty. Repair service, adjustment and calibration due to misuse, abuse or negligence are not covered by this warranty. Unauthorized service or modification to this product or of any furnished components will void this warranty in its entirety. This warranty does not include reimbursement for inconvenience, installation, set-up time, loss of use, postage, unauthorized service, or other products used in conjunction with, but are not supplied by, Dorcy.